



Rochester Avenue, Rochester, ME1 2DP
Asking price £275,000 Freehold

 3  1  1  D

The Homes Group are delighted to present to the market this newly decorated two/three-bedroom family home. Set in a sought-after location, between Rochester town center/Rochester Station and the popular Rochester Grammar Schools, this house would make the ideal first purchase or Buy-to-Let investment property.

Benefits include: Two double size bedrooms with a third bedroom leading off bedroom two (currently used as a dressing room), living room with log burner, fitted kitchen/diner with stainless steel electric oven and stainless steel gas hob, usable cellar with power and light, bathroom with modern white suite, double glazing, central heating, rear garden with rear access to an area where the current owners park their car, front yard, period features - feature fireplaces, panel doors and plaster works.

The layout of the rooms as below:

Entrance hall

Lounge

13'4 into bay x 9'4 (4.06m into bay x 2.84m)

Kitchen/diner

12'2 x 11'2 (3.71m x 3.40m)

Rear lobby

6'8 x 4'0 (2.03m x 1.22m)

Bathroom

6'7 x 6'2 (2.01m x 1.88m)

Cellar

12'0 x 10'10 (3.66m x 3.30m)

Landing

Bedroom one

12'1 x 11'1 (3.68m x 3.38m)

Bedroom two

12'1 x 11'2 (3.68m x 3.40m)

Bedroom three/dressing room

10'5 x 6'9 (3.18m x 2.06m)

Rear garden

38'6 x 12'6 (11.73m x 3.81m)

Tenure: FREEHOLD

Council Tax: Band B





Basement
Approx. 15.5 sq. metres (166.9 sq. feet)

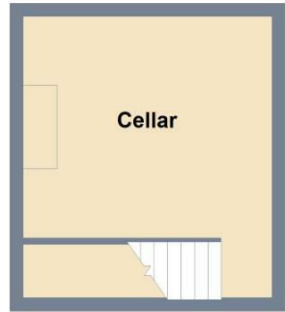

Ground Floor
Approx. 36.5 sq. metres (392.4 sq. feet)



First Floor
Approx. 35.5 sq. metres (381.8 sq. feet)



Total area: approx. 87.4 sq. metres (941.2 sq. feet)



Energy Efficiency Rating		
	Current	Potential
Very energy efficient - lower running costs		
(92 plus) A		
(81-91) B		78
(69-80) C		
(55-68) D	61	
(39-54) E		
(21-38) F		
(1-20) G		
Not energy efficient - higher running costs		
England & Wales	EU Directive 2002/91/EC	

Viewing

Please contact The Homes Group Office on 01322 875000 if you wish to arrange a viewing appointment for this property or require further information.

These particulars, whilst believed to be accurate are set out as a general outline only for guidance and do not constitute any part of an offer or contract. Intending purchasers should not rely on them as statements of representation of fact, but must satisfy themselves by inspection or otherwise as to their accuracy. No person in this firm's employment has the authority to make or give any representation or warranty in respect of the property.